

WEIGHT CAPACITY  
**80 Kg**



PRESSURE  
**0.7-0.8 Mpa**



VERTICAL LIFT  
**1800 mm**



VERSIONS  
RUNNING OVERHEAD

Pneumatic Manipulator **MINIPARTNER MP** with double cable

MINIPARTNER MP equipped with special gripping tools, allows the handling of loads in a weightless condition in any direction. The gripping tool is connected to the balancing group by two singles cables to guarantee max safety. Mounted on a bridge crane with double runways, it offers an easy translation in order to cover a large working area.

# MINIPARTNER<sup>®</sup> - MP

## Minipartner overhead trolley mounted - MPS

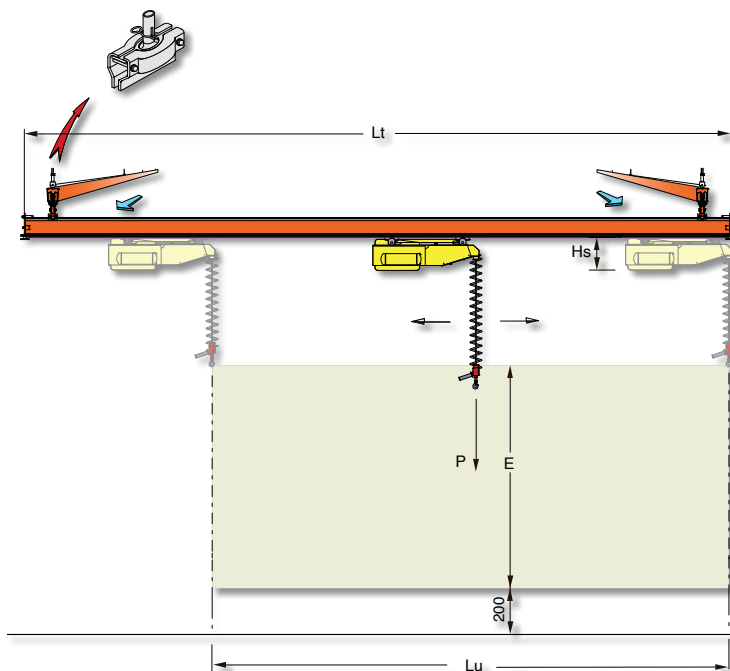

**MINIPARTNER overhead trolley mounted "MPS"**

|                     |   |           |    |
|---------------------|---|-----------|----|
| Max weight capacity | P   | 80        | Kg |
| Bridge length       | Lt  | 4000÷7000 | mm |
| Working length      | Lu  | 3100÷6100 | mm |
| Vertical lift       | E   | 1800      | mm |
| Overall dimension   | Hs  | 320       | mm |
| Air supply          | Dry and oil-free compressed air min. constant 0.7÷0.8 MPa |           |    |

Configuration and measurements may change upon the Customer's specific requirements

## Minipartner Plus overhead trolley mounted - MPS

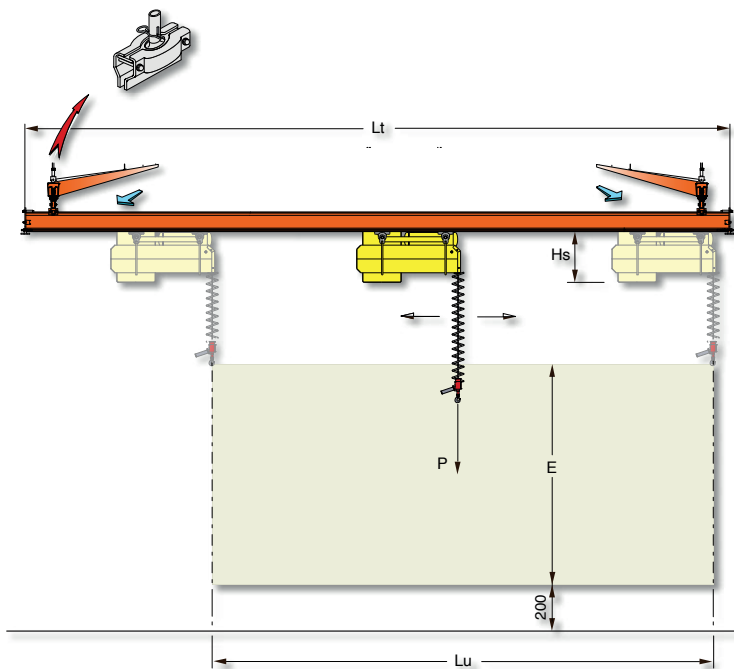

**MINIPARTNER PLUS**

| MODEL               | PLUS 8  | PLUS 6    |              |
|---------------------|---|-----------|--------------|
| Max weight capacity | P   | 170       | 220 Kg       |
| Bridge length       | Lt  | 4000÷7000 | 4000÷7000 mm |
| Working length      | Lu  | 3250÷6250 | 3250÷6250 mm |
| Vertical lift       | E   | 2000      | 1500 mm      |
| Overall dimension   | Hs  | 435       | 435 mm       |
| Air supply          | Dry and oil-free compressed air min. constant 0.7÷0.8 MPa |           |              |

Configuration and measurements may change upon the Customer's specific requirements

Air supply: dry and oil-free compressed air min. constant 0.7÷0.8 MPa